

MAINTAINING TRAFFIC



2021 CONSTRUCTION SEASON

Reconstruction of Townsend Drive

▶ Stage 1

Temporary paving and prep for Stage 2.

▶ Stage 2

Both directions of traffic shifted to southbound roadbed. Reconstruct the northbound roadway section.

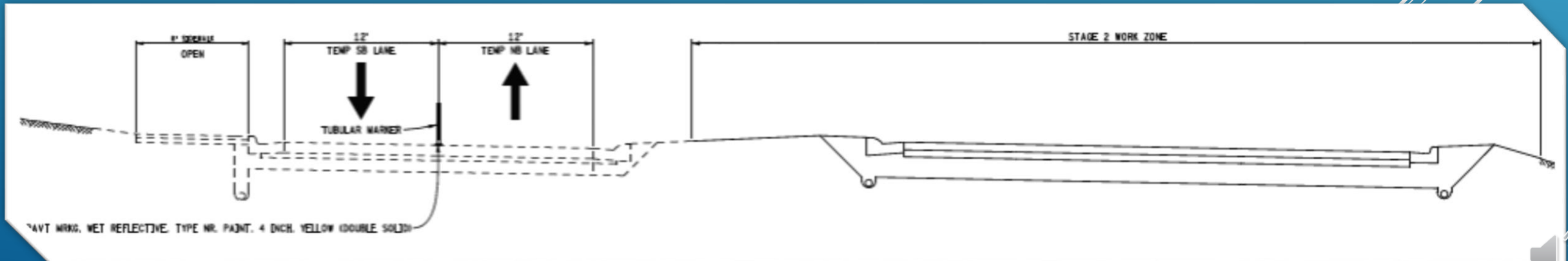

2021 CONSTRUCTION SEASON

Reconstruction of Townsend Drive

► Stage 3

Northbound traffic detoured onto Cliff Drive.

Reconstruction of the southbound roadway section.

MacInnes Drive constructed in multiple stages.

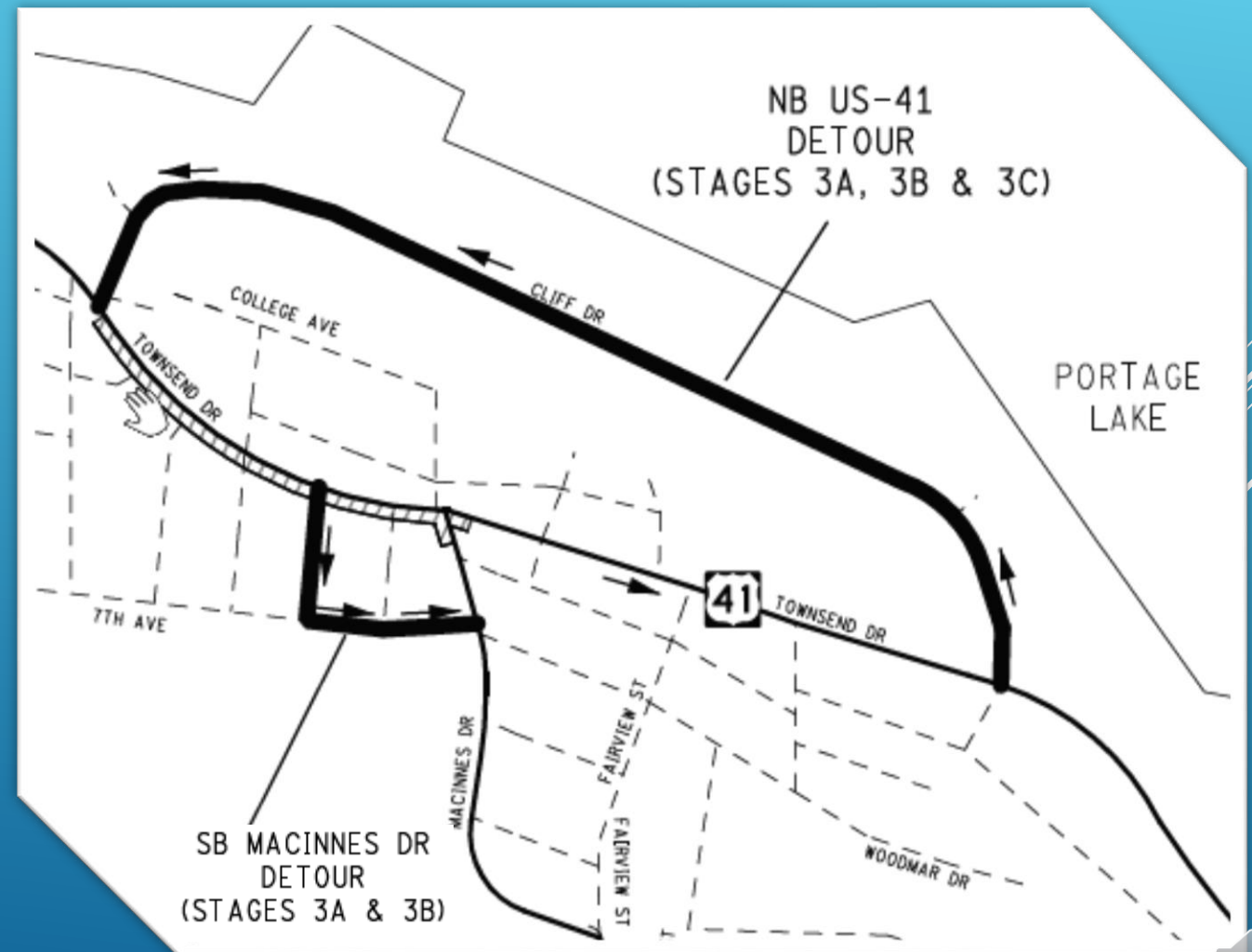

2022 CONSTRUCTION SEASON

Reconstruction of College Avenue, Montezuma Avenue, and Franklin Square

- ▶ Southbound US-41 detour
- ▶ Local traffic maintained, Montezuma Avenue to Sheldon Avenue
- ▶ Temporary traffic signals

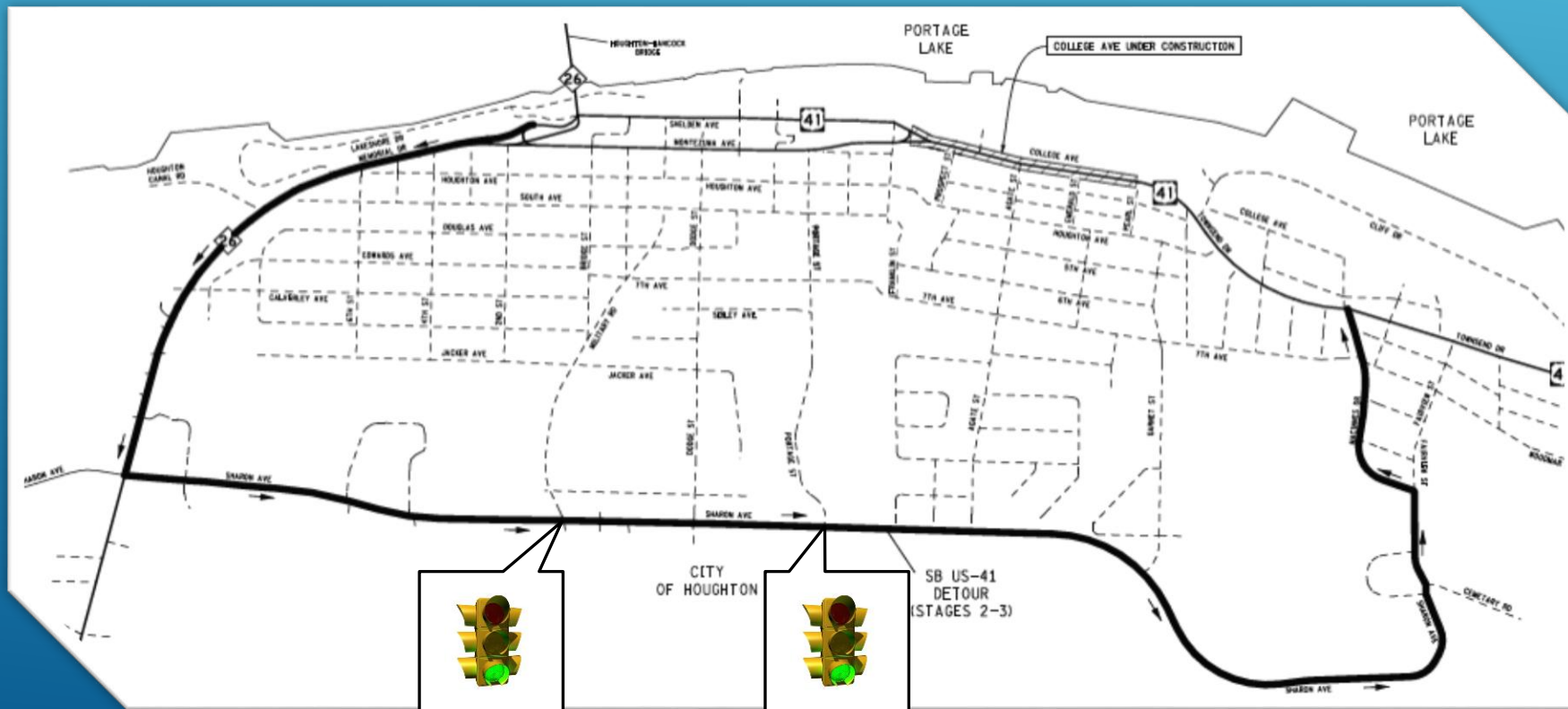

2022 CONSTRUCTION SEASON

Reconstruction of College Avenue, Montezuma Avenue, and Franklin Square

Northbound traffic will be maintained at all times.

