

Franklin Square Inn/Magnuson roof is approximately 61' above Shelden level and approx. 79' above parking level on north side at present. Approved site plan for Hampton Inn has an additional architectural feature at 68' above Shelden and 85' above the north side parking.

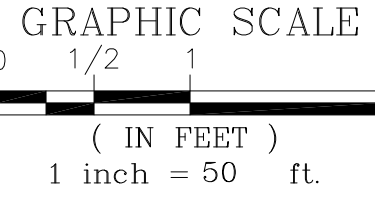

DOWNTOWN AREA BUILDING HEIGHT

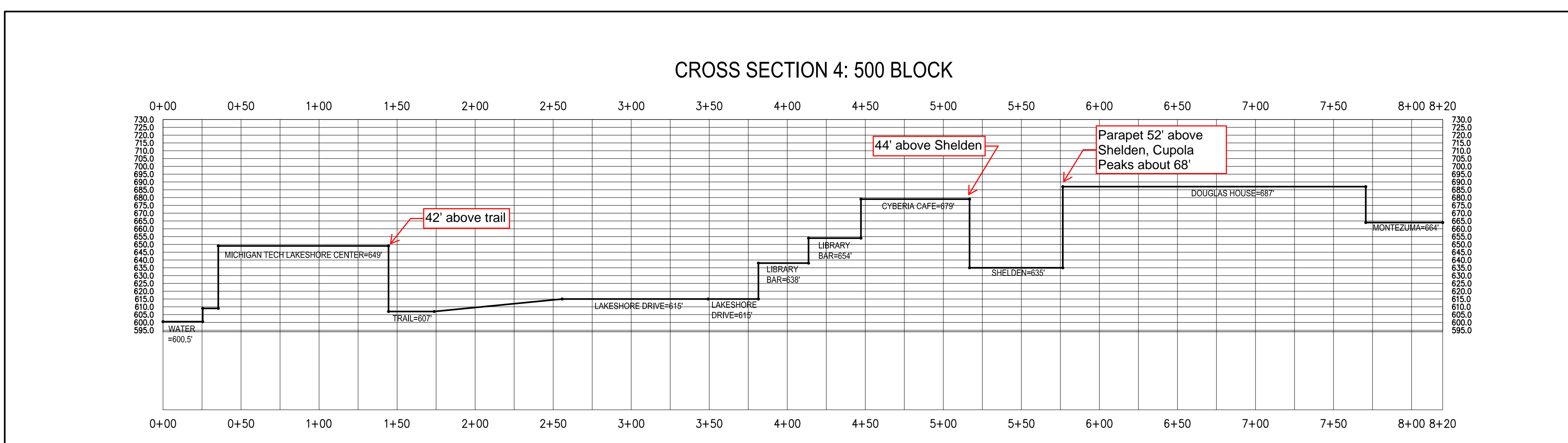
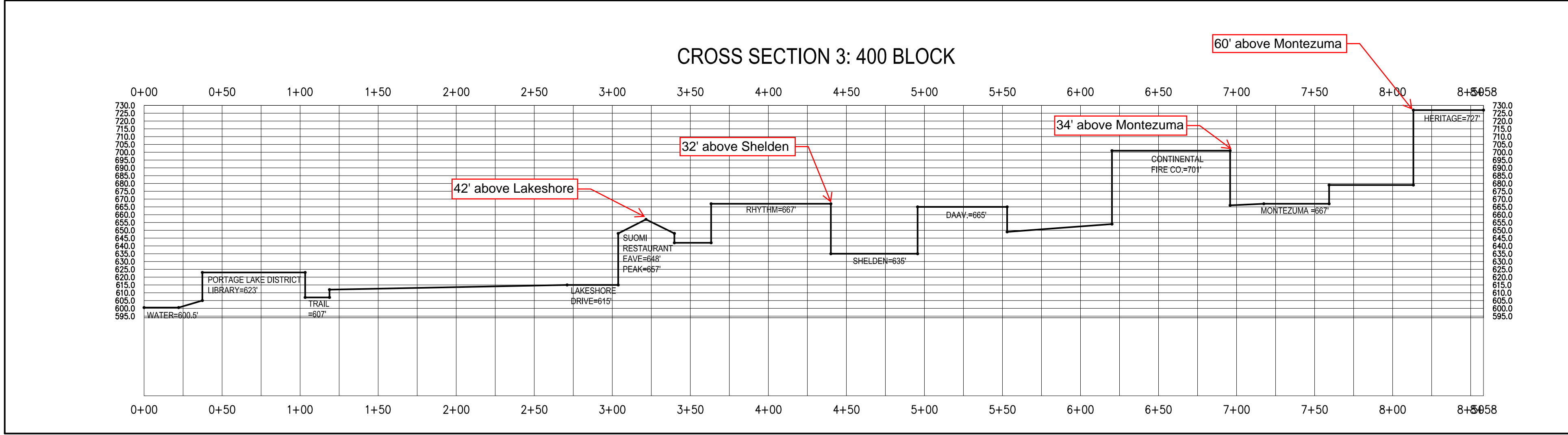
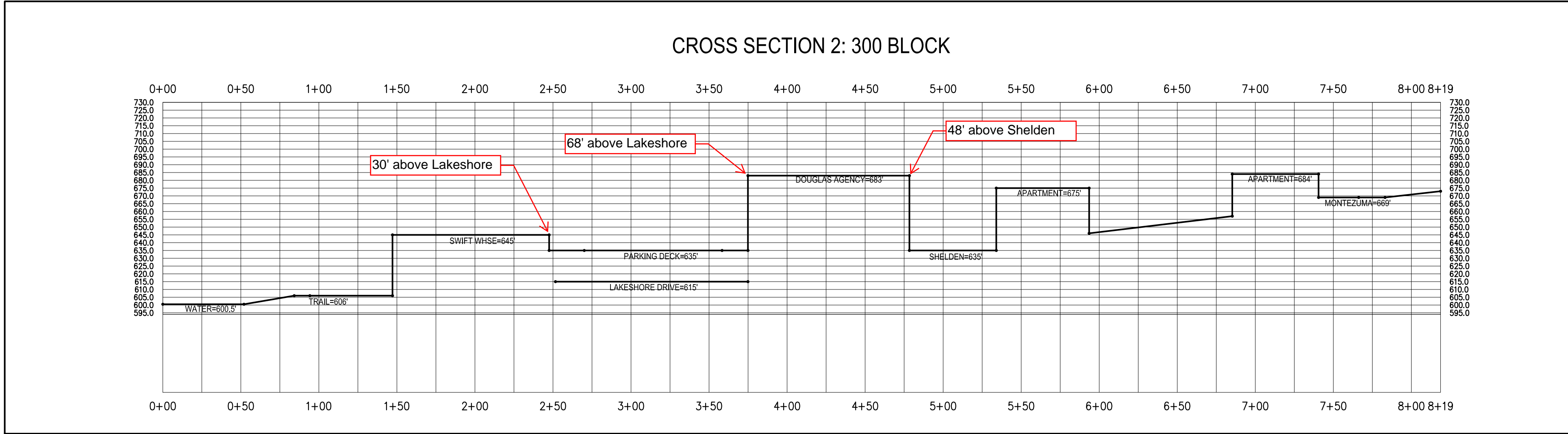

CITY OF HOUGHTON
HOUGHTON, MI

ISSUED FOR:	DATE:
CITY OF HOUGHTON	4/15/2020
FINAL	4/15/2020
###	###
###	###
###	###
###	###
###	###
###	###
###	###
###	###
###	###
###	###
###	###

DOWNTOWN AREA BUILDING HEIGHT
CITY OF HOUGHTON
PROJECT NO: H02-00130
DESIGNED BY: KPK
DRAWN BY: KPK
CHECKED: JYW
APPROVED: JYW

BUILDING HEIGHT EVALUATION

2 OF 2