

7/10/2024

## Variance Request

106 W. South Ave.  
Houghton, MI 49931

Zoning Board of Appeals Members:

Ms. Linda Lohman requests a front yard and side yard variance at her residence of 106 W. South Ave. for a proposed attached garage.

The proposed is on a 50' x 100' lot located in the R1 Single Family District. The front yard setback by City Ordinance is set at 25', side yard 5' and rear yard 15'. The front of the attached garage is proposed to be built 12' from the front property line, thus a request for a 13' variance. The west side of the building is proposed to be built 3' from the west property line, thus a request for a 2' variance.

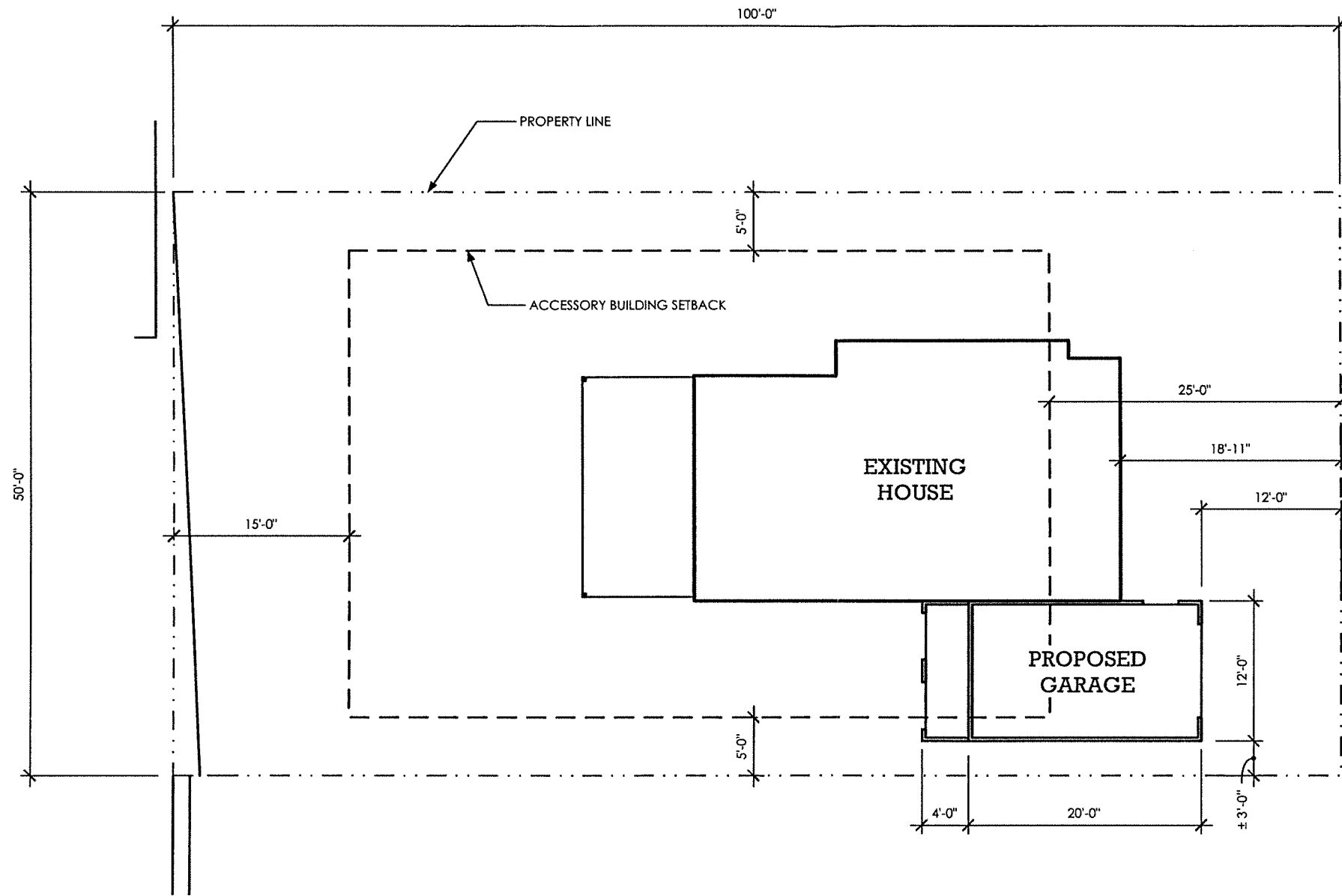

PROPOSED SITE PLAN W/ SETBACKS

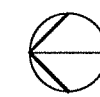

1" = 10'-0"

JOHN  
ARNOLD  
ARCHITECT  
STUDIO.01M@GMAIL.COM

CLIENT  
LINDA LOHMANN  
106 WEST SOUTH AVE  
HOUGHTON, MI 49931

ISSUE  
06-29-2024  
RE-ISSUE  
MM.DD.YY

PROJECT NO.  
2022-LL  
PROJECT  
ADDITION

DRAWN BY  
JA  
DESCRIPTION  
SITE FOR ZONING  
CONVERSATION

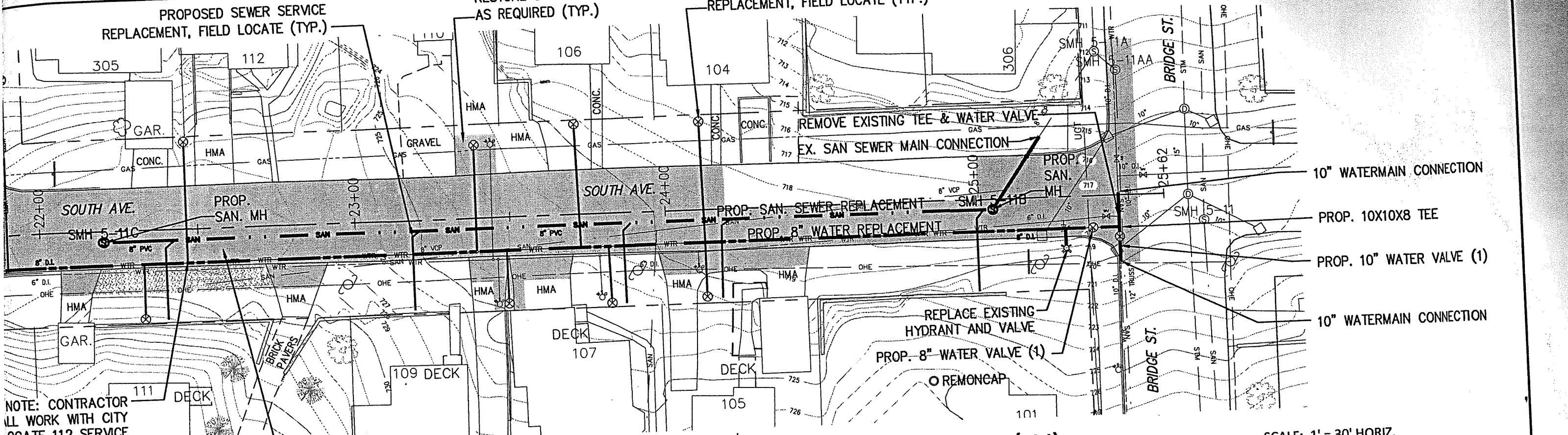
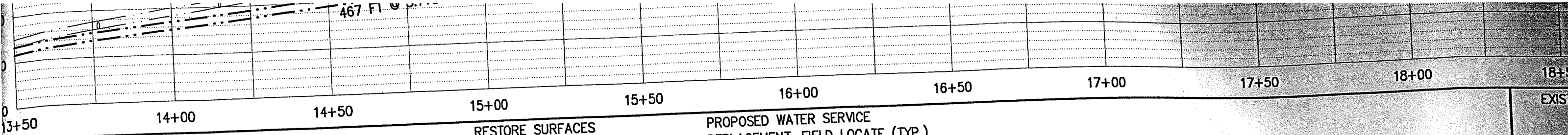

NOTE: CONTRACTOR  
 ALL WORK WITH CITY  
 LOCATE 112 SERVICE  
 AND ATTEMPT TO  
 CONNECT IN 112 LOT  
 AS SHOWN. ABANDON  
 AT SOUTH AND 1ST  
 STREET.

SEE WATER &  
 SEWER NOTE 23  
 SHEET C001

**SOUTH AVE. - STA. 22+00 TO 25+62 (60' R/W)**

SCALE: 1" = 30' HORIZ.  
 1" = 10' VERT.

